

SERIES S 10 | LINE REGULATOR

- Diaphragm single stage
- Balanced-Valve Technology
- Purity up to 6.0
- Inlet pressure:
25 bar (360 psi)
- Outlet pressure:
3 bar (44 psi)
or 8 bar (116 psi)

- ★ Compact design
- ★ Reduce the ownership cost
- ★ Front panel mounting
- ★ O₂ application compatible

Special requirements on request

APPLICATIONS

- Designed as a second stage line regulator for laboratory applications such as: gas delivery to inductive plasma spectrometer, protection and support gas for chromatograph, environmental emission monitoring, industrial hygiene or safety monitors and trace impurity analyzers.
- Ideally suited as a NH₃ line regulator (EPDM stainless steel version).

KEY FEATURES

- As a second level of regulation, the SL 10 will supply a precise outlet pressure to the process. It can be used for many applications that need a high flow.
- Flexible wall or panel mounting possible with its compact design, the rear threads and fixing ring.
- Best-in-class pressure control with Balanced-Valve Technology: the effect of inlet pressure fluctuations on outlet pressure are minimized. BV-technology delivers an exceptionally stable outlet pressure and flow even with high flow line regulators.
- Longer useful regulator lifetime and lower total ownership cost.

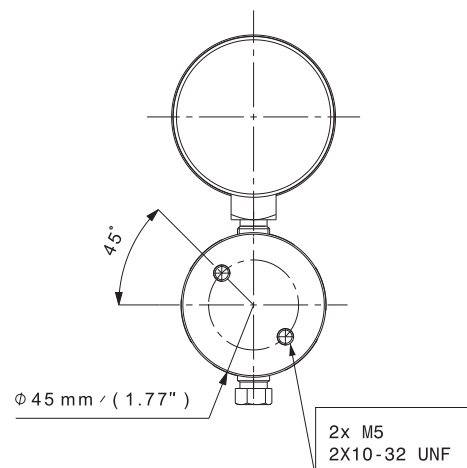
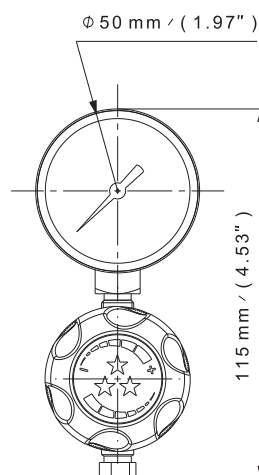
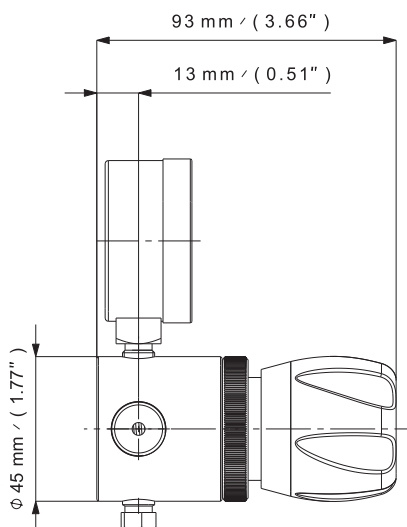

LOW-PRESSURE REGULATORS

SPECIFICATIONS

Female ports	G 3/8 or 1/4 NPT (inlet/outlet)	Weight	± 0,6 kg ± 1.32 lbs	Inlet pressure max	25 bar 360 psi
Seat seal	NBR (brass version) FPM (SS version)	Leak rate	10 ⁻⁸ mbar ℓ/s He	Outlet pressure	3/8 bar 44/116 psi
O-ring	NBR (brass version) FPM (SS version) EPDM	Temperature range	- 20°C to + 60°C - 4°F to + 140°F	Nominal Flow	4,5/12 Nm³/h (N₂)
Diaphragm	AlSi 304 (brass version) Hastelloy® (SS version)	Gauges	Low pressure (M10 x 1 or 1/4 NPT)	Oxygen use	OK for brass and stainless steel

FLOW CURVES

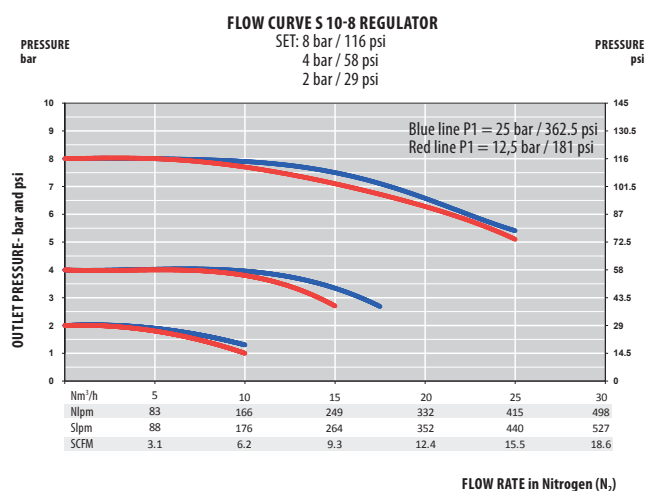
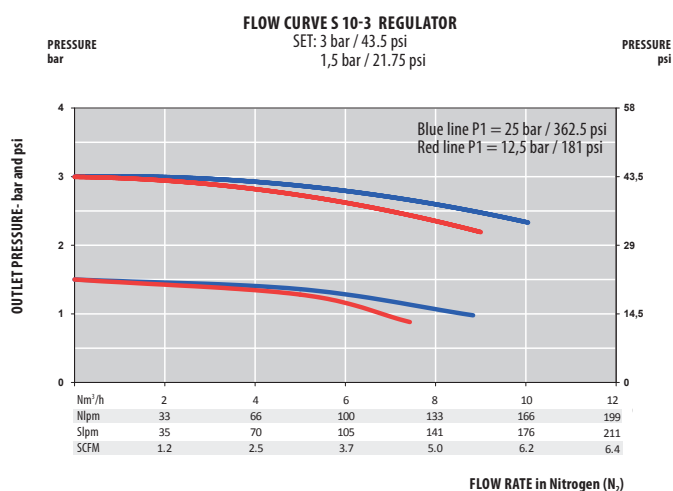

PRODUCT CONFIGURATOR

Body Material		10	Outlet Pressure		End Connections		O-ring Material	Gauges	Mounting		Ports Configuration	
S	L		8		G		NBR	1	FR0		A	
Chrome plated brass	L		3 bar 44 psi	3	G 3/8 - G 3/8	G	NBR - Standard with brass version	Without	0	Without Fixing Ring	FR0	Standard Configuration
Stainless steel	I		8 bar 116 psi	8	1/4 NPT - 1/4 NPT	N	FPM - Standard with stainless steel version EPDM	With	1	With Fixing Ring	FR1	Reverse inlet/outlet



WolfLabs

Pricing on any accessories shown can be found by keying the part number into the search box on our website.

The specifications listed in this brochure are subject to change by the manufacturer and therefore cannot be guaranteed to be correct. If there are aspects of the specification that must be guaranteed, please provide these to our sales team so that details can be confirmed.

www.wolflabs.co.uk

Tel : 01759 301142

Fax : 01759 301143

sales@wolflabs.co.uk

Please contact us if this literature doesn't answer all your questions.